

QUALITY, PRECISION &
RELIABILITY

LAL'S
ASPHALT & CONCRETE EQUIPMENT

COMPANY PROFILE

LAL'S EXPORTERS (INDIA) PVT. LTD. IS AN ISO 9001:2015 CERTIFIED COMPANY PRODUCING A VAST RANGE OF ASPHALT & CONCRETE CONSTRUCTION EQUIPMENT. MANAGED BY A TEAM OF PROFESSIONALS HAVING AN INDUSTRY EXPERIENCE OF OVER 20 YEARS ACROSS VARIOUS DOMAINS OF CONSTRUCTION INDUSTRY. OUR PRODUCTS ARE SEEDED ALL ACROSS THE GLOBE WITHIN A DECADE WITH REPEATED ORDERS.

LAL'S DEDICATED TEAM OF ENGINEERS ARE WORKING CONTINUOUSLY WITH LATEST SOFTWARE AND CUTTING-EDGE TECHNOLOGIES TO ENHANCE DESIGN & PRODUCT EXCELLENCE. WE ADHERE TO QUALITY PROCESSES CONFIRMING TO **IS, DIN & EUROPEAN STANDARDS**, SETTING HIGHER BENCHMARKS IN PRODUCT EXPERIENCE AND SATISFACTION. THIS COMMITMENT IS REFLECTED IN THE ISO 9001 CERTIFICATION FROM EURO UK ACCREDITATION LICENSING SERVICES.

PRODUCT PORTFOLIO

- ASPHALT DRUM MIX PLANTS (CONTINUOUS TYPE)
- ASPHALT BATCH MIX PLANTS
- WET MIX MACADAM PLANTS (SOIL STABILIZATION PLANTS)
- DUAL APPLICATION ASPHALT PAVER FINISHERS (SENSOR & MECHANICAL)
- INLINE STATIONARY CONCRETE BATCHING PLANTS
- COMPACT CONCRETE BATCHING PLANTS
- PORTABLE CONCRETE BATCHING PLANTS
- MOBILE CONCRETE BATCHING PLANTS (WITH REVERSIBLE MIXER)
- REVERSIBLE CONCRETE MIXERS
- TRUCK MOUNTED BITUMEN SPRAYERS
- TROLLEY MOUNTED BITUMEN SPRAYERS
- ROAD SWEEPERS (HYDRAULIC BROOM)
- ROAD MARKING MACHINES
- STONE CRUSHERS

CERTIFICATION / ACCREDITATION / MEMBERSHIP



ASPHALT DRUM MIX PLANT

HOT MIX ASPHALT IS A COMBINATION OF APPROXIMATELY 95% STONE AGGREGATES, SAND OR GRAVELS BOUND TOGETHER BY ASPHALT CEMENT (BITUMEN). THESE RAW MATERIALS ARE HEATED, DE-MOISTURISED AND MIXED IN A PRE-DETERMINED PROPORTION IN A MIXER NAMED HOT MIX PLANT. THE MOST COMMON PLANT TO PRODUCE SUCH HOT MIX IS DRUM MIX PLANT (CONTINUOUS TYPE HOT MIX PLANT).

VARIANTS PROCESS WISE



PARALLEL FLOW



COUNTER FLOW

VARIANTS INSTALLATION WISE



STATIONARY PLANT



MOBILE (WHEELED PLANT)

VARIANTS CAPACITY WISE

25 - 30 TPH

30 - 45 TPH

45 - 60 TPH

60 - 90 TPH

90 - 120 TPH

120 - 150 TPH

****HIGHER CAPACITY PLANTS ARE ALSO AVAILABLE ON REQUEST.**

MAJOR COMPONENTS

COLD FEED BINS

COLD AGGREGATE FEEDER BINS ARE MADE OF THICK STEEL PLATES AND RE-INFORCED WITH STIFFENERS. IT CONSISTS OF ANTI-BRIDGING BIN HOPPERS, FEEDER BELTS AND GATHERING / COLLECTING CONVEYOR. FEEDER BELTS ARE DRIVEN BY INDIVIDUAL VARIABLE FREQUENCY DRIVES FOR ACCURATE FEEDING OF AGGREGATES / SAND AS PER DESIGN MIX.



VIBRATORY SCREEN (SCALPING SCREEN)

A SINGLE DECK VIBRATORY SCREEN FOR SCALPING OF OVERSIZE AGGREGATES. CHOICES OF MESH SIZE ARE AVAILABLE.



SLINGER CONVEYOR (INCLINED CONVEYOR)

ENABLER TO MOVE AGGREGATES RECEIVED FROM SCALPING SCREEN TO THERMO DRUM UNIT. IT IS FITTED WITH ACCURATE AND RELIABLE CONTINUOUS BELT WEIGHING MECHANISM (LOAD CELL) WHICH PRECISELY WEIGHS THE QUANTITY OF THE AGGREGATES ENTERING THE THERMO DRUM.



THERMO DRUM CUM MIXING UNIT

A UNIAXIAL DRUM MADE OUT OF HEAT RESISTANT STEEL WITH GENEROUS INSULATION ON TOP (FOR OPTIMIZING THERMAL EFFICIENCY) AND CLADDED WITH STAINLESS STEEL IS PROVIDED. APPROXIMATELY 2/3 PART OF THE DRUM IS USED FOR DRYING OF AGGREGATES AND BALANCE 1/3 FOR MIXING OF HEATED AGGREGATES WITH BITUMEN (ASPHALT) AND FILLER MATERIAL IN SEQUENTIAL ORDER TO PRODUCE A HOMOGENOUS MIX IN ADHERENCE TO JOB MIX FORMULA.

INNER DRUM IS FITTED WITH THREE TYPES OF FLIGHTS—CONDITIONING & SHOWERING FLIGHTS IN HEATING ZONE AND MIXING FLIGHTS IN MIXING ZONE OF DRUM. BOTH THE ZONES ARE SEPARATED BY A FLAME GUARD.



DRYER BURNER

OUR BURNERS ARE DESIGNED FOR COMPACT FLAME SHAPE, RELIABLE FIRING, EFFICIENT COMBUSTION AND LOW NOISE EMISSION.

OPTIONS

- FUEL TYPE - SINGLE, DUAL, MULTI FUEL & WASTE OIL
- OPERATION - ON / OFF, HIGH / LOW AND MODULATING



FUEL TANK

A DAY TANK FOR SUPPLY OF FUEL TO BURNERS IS PROVIDED.

OPTIONS

- LARGER CAPACITY STORAGE TANKS ARE AVAILABLE ON REQUEST



MIX LOAD OUT CONVEYOR

AN INCLINED LOAD OUT HEAT RESISTANT BELT CONVEYOR IS PROVIDED FOR CONVEYING HOT MIX FROM THERMO DRUM TO SURGE HOPPER WHICH COLLECTS HOT MIX & DISCHARGES IN TRUCKS WITH MINIMUM SEGREGATION.

OPTIONS

- STORAGE SILOS ARE AVAILABLE ON REQUEST



BITUMEN (ASPHALT) TANK

AN INSULATED BITUMEN TANK FITTED WITH DIRECT FIRE OIL BURNER IS PROVIDED FOR HEATING OF BITUMEN UPTO REQUIRED TEMPERATURE. BURNER IS FITTED WITH THERMO-STAT FOR AUTO CUT-OFF AFTER REACHING PRE-SET TEMPERATURE.

A THERMIC OIL JACKETED BITUMEN (ASPHALT) METERING PUMP WITH VFD CONTROL IS PROVIDED FOR PRECISE METERING OF ASPHALT / BITUMEN TO BE PUMPED AS PER THE JOB MIX FORMULA IN THE THERMO DRUM UNIT.

OPTIONS

- CAPACITY - 15 / 20 / 25 / 30 / 40 MT
- ROUND SHAPED / U SHAPED / VERTICAL SHAPED
- ELECTRICALLY HEATED THERMIC OIL TANK (JACKETING PURPOSE) WITH PUMP
- INDIRECT FIRED (THERMIC OIL HEATED) TANKS WITH THERMIC OIL HEATER



AIR POLLUTION CONTROL SYSTEM

HOT MIX PLANTS ARE NOW AN ENVIRONMENT FRIENDLY MACHINES AND CAN BE INSTALLED IN ANY LOCALITY AND MEET THE EMISSION NORMS REQUIRED FOR OPERATION OF SUCH MACHINES IN THAT AREA. ONE CAN CHOOSE FROM THREE AVAILABLE OPTIONS:

PRIMARY DUST COLLECTOR: A PRIMARY DUST SEPARATION SYSTEM CAN SEPARATE COARSE & FINE DUST PARTICULATES AND ALLOW ONLY PARTICLES LESSER THAN 75 MICRONS TO ESCAPE IN ENVIRONMENT.



WET SCRUBBER: IT IS AN INTEGRAL UNIT CONTAINING PRIMARY DUST COLLECTION SYSTEM AND SECONDARY DUST SUPPRESSION SYSTEM. IN THIS, COARSE PARTICLES ARE COLLECTED AND FINES PARTICULATES LESS THAN 75 MICRONS ARE ALLOWED TO ENTER THE WET SCRUBBER WHERE IN WATER IS SPRAYED ON THESE PARTICLES AND CONVERTED INTO SLUDGE. EMISSIONS IS REDUCED TO 150 MG/M³.



BAG HOUSE FILTER SYSTEM: A FILTER BAG SYSTEM WITH ADEQUATE AIR TO CLOTH RATIO IS PROVIDED FOR COLLECTION OF COARSE AS WELL AS FINE PARTICLES AND ALLOWING EMISSIONS OF 50 MG/M³ ONLY. EMISSIONS CAN BE FURTHER REDUCED TO LESS THAN 20 MG/M³ IN CASE OF ATTAINMENT AREAS.



**** EMISSIONS ARE SUBJECT TO CLEAN AGGREGATES AND DUST LOADS.**

ADDITIVE FILLER UNIT (FINES FILLER)

FINES FILLER UNIT IS FITTED WITH VFD OPERATED ROTARY VALVE AND PNEUMATIC CONVEYING SYSTEM FOR PRECISE DOSING OF FINES IN MIXING ZONE OF THERMO DRUM AS PER JOB MIX DESIGN.

OPTION

- BIGGER CAPACITY SILOS
- SCREW CONVEYOR SYSTEM



CONTROLS

AN AUTOMATIC SYSTEM IS PROVIDED FOR PROPORTIONAL CONTROL OF AGGREGATES, BITUMEN / ASPHALT & ADDITIVES AND BLENDING IT AS PER MIX DESIGN. THIS SYSTEM ACTS AS PER THE JOB MIX FORMULA AND PARAMETERS ENTERED. IT CONTROLS AND MONITORS THE FOLLOWING:

- ON / OFF POWER CONTROLS
- DISPLAYS ALL PROCESS CONTROL PARAMETERS
- AGGREGATE, BITUMEN AND ADDITIVE PROPORTIONS
- AGGREGATE, BITUMEN, HOT MIX AND EXHAUST TEMPERATURE
- MATERIAL MIX DESIGN TOLERANCE FOR MIXING AND BLENDING
- NO FLOW ALARMS
- COMPLETE JOB MIX FORMULA
- DISCHARGE TO TRUCKS
- BURNER CONTROL
- PRINTOUT OF PROCESS CONTROLS, JOB MIXING FORMULA AND TONNAGE PRODUCED
- PLANT OPERATING CAPACITIES
- INTERLOCKING SYSTEM FOR PLANT'S SAFETY
- ELECTRIC MOTOR POWER FAILURE INDICATORS
- MANUAL OVERRIDE SYSTEM



CUSTOMERS CAN CHOOSE FROM THE BELOW CONTROL OPTIONS

- MICROPROCESSOR BASED RELAY CONTROL SYSTEM
- HMI BASED CONTROL SYSTEM
- PLC BASED CONTROL SYSTEM
- OPTION TO INTEGRATE SCADA, REMOTE MONITORING AND MOBILE APP INTERFACE TO ABOVE SYSTEM



AN AIRCONDITIONED CONTROL ROOM WITH ALL ROUND VISION HOUSING CONTROL SYSTEM IS AN INTEGRAL PART OF THE SUPPLY

TOWARDS GREEN ROADS

WITH DIMINISHING NATURAL RESOURCES AND EMPHASIS ON SUSTAINABLE ROADS, THE USES OF RECLAIMED ASPHALT PAVEMENT (RAP) IS THE TREND OF THIS MILLENNIUM. RAP ENABLED PLANTS CAN HELP IN BUILDING SUSTAINABLE ROADS, CONSERVATION OF RESOURCES & ENVIRONMENT, HIGHER ROI AND RELATIVELY MORE DURABLE ROADS WITH GREATER LIFE CYCLES.

WE OFFER UPTO 70% RAP COMPATIBLE PLANT WITH CORRESPONDING RAP FEED BINS, MODIFIED THERMO DRUM UNIT, EXHAUST SYSTEM AND CONTROLS.

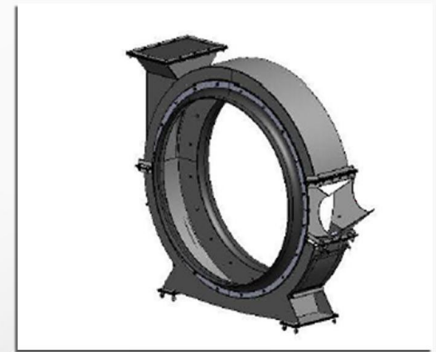
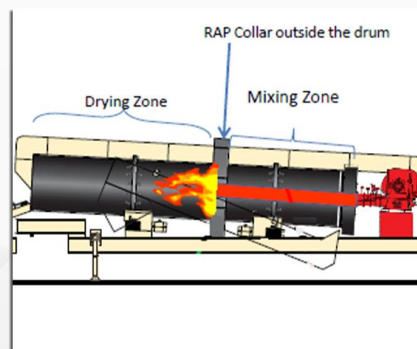

TECHNICAL SPECIFICATION

MODEL	LDMX-30	LDMX-45	LDMX-60	LDMX-90	LDMX-120	LDMX-150
CAPACITY	(25-30 TPH)	(30-45 TPH)	(45-60 TPH)	(60-90 TPH)	(90-120 TPH)	(120-150 TPH)
COLD FEED BINS						
NO. OF BINS	2	4	4	4	4	5
TOTAL STORAGE CAPACITY (TON)	15	30	40	50	60	75
BIN FEEDER DRIVE (HP X NOS)	2 X 2	2 X 4	2 X 4	2 X 4	3 X 4	3 X 5
BIN FEEDER BELT (MM)	500	500	500	500	500	600
GATHERING CONVEYOR DRIVE (HP)	3	5	5	5	7.5	10
GATHERING CONVEYOR WIDTH (MM)	500	500	600	600	600	600
FINE BIN VIBRATOR (HP)	N/A	0.25	0.25	0.5	0.5	0.5 X 2
VIBRATING SCREEN						
MOTOR (HP)	N/A	1	1	1	2	2
WIRE MESH (MM)	N/A	40	40	40	40	40
SLINGER CONVEYOR						
DRIVE MOTOR (HP)	3	3	5	5	7.5	10
CONVEYOR WIDTH (MM)	500	500	500	500	600	600
THERMO DRYER DRUM CUM MIXING UNIT						
DRUM (DIA & LENGTH) (MM)	1000 X 4000	1100 X 5000	1220 X 6000	1520 X 7100	1820 X 8000	2000 X 8300
CERAWOOL INSULATION (MM)	35	35	35	35	35	35
DRUM DRIVE MOTOR (HP)	10	15	20	30	40	50
DRYER BURNER						
BURNER TYPE	ON / OFF	2 STAGE (HIGH - LOW)	2 STAGE (HIGH - LOW)	2 STAGE (HIGH - LOW)	MODULATING	MODULATING
BLOWER POWER (HP)	3	5	5	10	15	25
BURNER RATING (LITER / HR.)	150	180	250	350	550	750
EXHAUSTER (CFM)	5,500	10,500	12,500	14,500	18,500	22,500
EXHAUST DRIVE MOTOR (HP)	10	15	20	25	50	60
INCLINED LOAD OUT CONVEYOR						
CONVEYOR DRIVE MOTOR (HP)	3	3	5	5	7.5	10
CONVEYOR WIDTH (HR TYPE) (MM)	500	500	600	600	600	600
GOB HOPPER						
GOB HOPPER CAPACITY (TON)	0.8	0.8	0.8	1.5	1.5	2
HYDRAULIC POWER PACK (HP)	2	2	2	5	5	5
BITUMEN TANK						
CAPACITY (MT)	15	15	20	20	25	30
GLASSWOOL INSULATION (MM)	50	50	50	50	50	50
BITUMEN METERING PUMP (HP)	3	3	3	3	3	5
MINERAL (ADDITIVE / FINES) FILLER						
FILLER UNIT CAPACITY (TON)	N/A	1.5	1.5	1.5	2	2
ROTARY VALVE (HP)	N/A	1	1	1	1	1
MINERAL FILLER BLOWER (HP)	N/A	1.5	1.5	1.5	2	2
FUEL TANK						
CAPACITY (LITER)	1,000	5,000	5,000	5,000	10,000	12,000
FUEL PUMP (HP)	2	2	2	2	5	5
WATER POLLUTION CONTROL SYSTEM (WET SCRUBBER)						
WATER PUMP (HP)	1.5	1.5	2	2	3	5
NOZZLE X SIZE (NO X INCH)	2 X ½	2 X ½	2 X 1	2 X 1	3 X 1	3 X 1
OPEN LAND REQUIREMENT (METER)	20 X 20	25 X 25	30 X 30	40 X 40	50 X 50	60 X 60
TOTAL CONNECTED LOAD (KVA)	62.5	82	100	125	200	240



** CAPACITY @ 3 TO 5% MOISTURE CONTENT IN AGGREGATE

** THE ABOVE TECHNICAL SPECIFICATION IS FOR STANDARD CONFIGURATION AND SCOPE OF SUPPLY MAY VARY AS PER QUOTATIONS.

ASPHALT BATCH MIXING PLANT

ASPHALT BATCHING PLANT IS A TYPE OF HOT MIX PLANT WHERE HEATING OF AGGREGATES TAKES PLACE IN THERMO DRUM AND MIXING IT WITH BITUMEN AND ADDITIVES IS DONE IN TWIN SHAFT PUG MILL MIXER IN SMALL BATCHES. THERE IS A TIME GAP BETWEEN TWO MIXING BATCHES SO IT IS ALSO KNOWN AS DISCONTINUOUS TYPE HOT MIX PLANT.

OUR PLANTS ARE OF MODULAR TYPE WITH EASE OF ERECTION AND DISMANTLING BUILT IN. YOU CAN CHOOSE FROM DIFFERENT CAPACITIES FROM 80 TPH UPTO 240 TPH.

MODEL	CAPACITY
LBMX-800	80 TPH
LBMX-1000	100 TPH
LBMX-1200	120 TPH
LBMX-1600	160 TPH
LBMX-2000	200 TPH
LBMX-2400	240 TPH



SCOPE OF SUPPLY

- COLD FEED BINS
- SINGLE DECK SCALPING SCREEN
- INCLINED SLINGER CONVEYOR
- THERMO DRUM FITTED WITH BURNER
- BUCKET ELEVATOR FOR HOT AGGREGATES
- MULTI DECK SCREENING UNIT
- HOT BINS FOR STORAGE OF HOT SCREENED AGGREGATES
- AGGREGATE, BITUMEN AND FILLER WEIGHING MECHANISM
- TWIN SHAFT PUGMILL FOR MIXING OF HOT MIX MATERIAL
- BITUMEN HEATING AND STORAGE TANK
- THERMIC OIL HEATER
- FUEL STORAGE TANK
- ADDITIVE / FILLER SILO
- BAG HOUSE FILTER SYSTEM
- PLC BASED CONTROLS WITH AIR CONDITIONED CONTROL ROOM

OPTIONS

- RAP ENABLED PLANT

**FOR DETAILED TECHNICAL SPECIFICATIONS,
PLEASE ASK FOR TECHNO COMMERCIAL OFFER.



WET MIX MACADAM / SOIL STABILISATION PLANT

WET MIX MACADAM IS A ROAD CONSTRUCTION MATERIAL THAT IS USED FOR BASE & SUB BASE LAYERS. IT IS COMPOSED OF CRUSHED AGGREGATES INCLUDING GRAVEL AND STONE DUST MIXED WITH WATER AND BINDING AGENT SUCH AS BITUMEN EMULSION AND CEMENT OR AGGREGATE DUST & RED SOIL.

THE PLANT USED TO PREPARE SUCH WMM MATERIAL AUTOMATICALLY AS PER DESIGN MIX IS A WET MIX MACADAM PLANTS.

SCOPE OF SUPPLY

- COLD FEED BINS
- SINGLE DECK SCALPING SCREEN
- INCLINED SLINGER CONVEYOR
- TWIN SHAFT PUGMILL FOR MIXING
- LOAD OUT CONVEYOR WITH SURGE HOPPER
- ADDITIVE / FILLER SILO
- CONTROLS WITH AIR-CONDITIONED CONTROL ROOM

OPTIONS

- WMM STORAGE HOPPER WITH DISCHARGE SYSTEM
- WATER TANK
- HIGHER CAPACITY PLANTS ARE ALSO AVAILABLE ON SPECIFIC REQUEST

TECHNICAL SPECIFICATION

MODEL	LWMX-60	LWMX-100	LWMX-160	LWMX-200
CAPACITY	60 TPH	100 TPH	160 TPH	200 TPH
COLD FEED BINS				
NUMBER OF BINS	4	4	4	4
TOTAL STORAGE CAPACITY (TON)	32	40	48	60
FEEDER DRIVES (HP X NOS)	1.5 X 4	1.5 X 4	2 X 4	3 X 4
BIN FEEDER BELT (MM)	500	500	500	500
GATHERING CONVEYOR WIDTH (MM)	600	600	600	600
GATHERING CONVEYOR DRIVE (HP)	5	5	7.5	7.5
VIBRATING SCREEN				
MOTOR (HP)	0.5	0.5	0.5	0.5
WIRE MESH (MM)	65	65	65	65
SLINGER CONVEYOR				
DRIVE MOTOR (HP)	5	5	7.5	7.5
CONVEYOR WIDTH (MM)	600	600	600	600
PUG-MILL MIXER				
PUG MILL LINER PLATE	HARDOX	HARDOX	HARDOX	HARDOX
PUG MILL DRIVE MIXER (HP)	15	25	50	50
PUG MILL CAPACITY (M ³)	1.4	1.6	1.9	3
PADDLE ARMS & TIPS	NI-HARD	NI-HARD	NI-HARD	NI-HARD
INCLINED LOAD OUT CONVEYOR				
DRIVE MOTOR (HP)	5	5	7.5	7.5
BELT WIDTH (MM)	600	600	600	600
GOB HOPPER				
HOPPER CAPACITY (TON)	0.8	0.8	0.8	1.5
HYDRAULIC POWER PACK (HP)	3	3	3	5
MINERAL (ADDITIVE / FINES) FILLER				
FILLER UNIT CAPACITY (TON)	2	3	5	5
MINERAL FILLER BLOWER (HP)	2	2	3	3



ASPHALT PAVER FINISHER

A PAVER FINISHER IS A CONSTRUCTION EQUIPMENT UTILIZED TO LAY EVEN THICKNESS OF HOT MIX ASPHALT, WET MIX MACADAM, GRANULE SUB BASE MATERIAL OR DRY LEAN CONCRETE ON SURFACES LIKE ROADS, BRIDGES, PARKING LOTS AND OTHER SUCH PLACES. IT ALSO DOES MINOR COMPACTION TYPICALLY FOLLOWED BY FINAL COMPACTION BY ROAD ROLLERS.

VARIANTS

- MODEL LWP - 450 HES : MECHANICAL GRADE AND SLOPE CONTROL WITH 4.5 METER PAVING WIDTH
- MODEL LSP - 550 HES : SENSOR TYPE AUTOMATIC GRADE AND SLOPE CONTROL WITH 5.5 METER PAVING WIDTH

KEY FEATURES

- ELECTRONIC BS-IV / MECHANICAL BS-III ENGINE
- POWER STEERING
- AIR BRAKE
- MULTI APPLICATION
- ERGONOMIC CONTROLS
- SCREED HEATER SYSTEM
- S.S. / HARDOX LINED SCREED
- NI-HARD AUGER
- HYDRAULICALLY OPERATED HOPPER



****FOR DETAILED TECHNICAL SPECIFICATIONS, PLEASE ASK FOR TECHNO COMMERCIAL OFFER.**

CONCRETE BATCHING PLANT

A CONCRETE BATCHING & MIXING PLANT IS AN EQUIPMENT THAT COMBINES AND MIXES VARIOUS INGREDIENTS LIKE AGGREGATES, CEMENT, WATER, SAND, ADMIXTURE ETC. AS PER MIX DESIGN TO FORM CONCRETE CEMENT.

CAPACITIES - 8 TO 120 M³/HR. OUTPUTS

MIXER TYPES - TWIN SHAFT, PAN AND REVERSIBLE MIXER

VARIANTS - STATIONARY, COMPACT, PORTABLE AND MOBILE

STATIONARY / INLINE CONCRETE BATCHING PLANT (LSCP SERIES)

TECHNICAL SPECIFICATION						
MODEL	LSCP-30	LSCP-45	LSCP-60	LSCP-75	LSCP-90	LSCP-120
CAPACITY (M ³ /HR)	30	45	60	75	90	120
MIXER TYPE	PAN / TWIN SHAFT	PAN / TWIN SHAFT	TWIN SHAFT	TWIN SHAFT	TWIN SHAFT	TWIN SHAFT
BATCH CAPACITY (M ³)	0.5	0.75	1	1.25	2	3
MAIN MIXER DRIVE (HP)	30	40 / 30	25 X 2	30 X 2	50 X 2	75 X 2
NUMBER OF BINS (INLINE)	4	4	4	4	4	4
BIN STORAGE CAPACITY (M ³)	32	48	60	80	100	120
MATERIAL WEIGHING	INDEPENDENT DIGITAL LOAD CELL WEIGHING SYSTEM FOR AGGREGATE, CEMENT, WATER & ADDITIVE					
BATCH FEEDING	THROUGH INCLINED CONVEYOR BELT					
CONTROL PANEL	PLC BASED FULLY AUTOMATIC CONTROL PANEL WITH DELTA HMI DISPLAYS					
CONTROL ROOM	SIZE OF 6' X 6' - INSULATED, FITTED WITH GLASS SHIELD FOR FULL ALL-ROUND VIEW.					
TOTAL CONNECTED LOAD	82 KVA	125 KVA	160 KVA	200 KVA	300 KVA	400 KVA

**HIGHER CAPACITY PLANTS ARE ALSO AVAILABLE ON SPECIFIC REQUEST.



COMPACT CONCRETE BATCHING PLANT (LCP SERIES)

FEATURES

- SINGLE CHASSIS STRUCTURE
- UNIFIED WEIGHING & CHARGING BELT
- OCCUPIES LESSER SPACE
- EASY TO INSTALL



TECHNICAL SPECIFICATION

MODEL	LCP-20	LCP-24	LCP-30	LCP-45	LCP-60
CAPACITY (M ³ /HR)	20	24	30	45	60
MIXER TYPE	PAN	PAN	PAN / TWIN SHAFT	PAN / TWIN SHAFT	TWIN SHAFT
BATCH CAPACITY (M ³)	0.33	0.4	0.5	0.75	1
MAIN MIXER DRIVE (HP)	20	20	25	40 / 30	50
NUMBER OF BINS (2 X 2 CROSS BINS)	4	4	4	4	4
BIN STORAGE CAPACITY (M ³)	14	16	26	30	40
MATERIAL WEIGHING	INDEPENDENT DIGITAL LOAD CELL WEIGHING SYSTEM FOR AGGREGATE, CEMENT, WATER AND ADDITIVE				
BATCH FEEDING	THROUGH INCLINED CONVEYOR BELT				
CONTROL PANEL	PLC BASED FULLY AUTOMATIC CONTROL PANEL WITH DELTA HMI DISPLAYS				
CONTROL ROOM	SIZE OF 6' X 6' - INSULATED, FITTED WITH GLASS SHIELD FOR FULL ALL-ROUND VIEW				
TOTAL CONNECTED LOAD (KVA)	62	62	82	100	125

PORTABLE CONCRETE BATCHING PLANT (LPCP SERIES)

FEATURES

- MODULAR CHASSIS
- INDEPENDENT WEIGHING & CHARGING BELT
- OPTION FOR MOBILITY
- EASY TO INSTALL



TECHNICAL SPECIFICATION

MODEL	LPCP-15	LPCP-24	LPCP-30
CAPACITY (M ³ /HR)	15	24	30
MIXER TYPE	PAN	PAN	PAN
BATCH CAPACITY (M ³)	0.25	0.4	0.5
MAIN MIXER DRIVE (HP)	15	20	25
NUMBER OF BINS (2 X 2 CROSS BINS)	4	4	4
BIN STORAGE CAPACITY (M ³)	12	12	14
MATERIAL WEIGHING	INDEPENDENT DIGITAL LOAD CELL WEIGHING SYSTEM FOR AGGREGATE, CEMENT, WATER AND ADDITIVE		
BATCH FEEDING	THROUGH INCLINED CONVEYOR BELT		
CONTROL PANEL	PLC BASED FULLY AUTOMATIC CONTROL PANEL WITH DELTA HMI DISPLAYS		
CONTROL ROOM	SIZE OF 6' X 6' - INSULATED, FITTED WITH GLASS SHIELD FOR FULL ALL-ROUND VIEW		
TOTAL CONNECTED LOAD (KVA)	61	62	82

MOBILE CONCRETE BATCHING PLANT (LRMB SERIES)

FEATURES

- MOBILE CHASSIS
- INDEPENDENT WEIGHING & CHARGING BELT
- REVERSIBLE DRUM MIXER
- EASY TO INSTALL



TECHNICAL SPECIFICATION

MODEL	LRMB-15	LRMB-20	LRMB-30
CAPACITY (M ³ /HR)	15	20	30
MIXER TYPE	REVERSIBLE DRUM MIXER	REVERSIBLE DRUM MIXER	REVERSIBLE DRUM MIXER
BATCH CAPACITY (M ³)	0.4	0.5	0.75
MAIN MIXER DRIVE (HP)	10	12.5	20
NUMBER OF BINS (2 X 2 CROSS BINS)	4	4	4
BIN STORAGE CAPACITY (M ³)	10	12	14
MATERIAL WEIGHING	INDEPENDENT DIGITAL LOAD CELL WEIGHING SYSTEM FOR AGGREGATE, CEMENT, WATER AND ADDITIVE		
BATCH FEEDING	THROUGH INCLINED CONVEYOR BELT		
CONTROL PANEL	PLC BASED FULLY AUTOMATIC CONTROL PANEL WITH DELTA HMI DISPLAYS		
CONTROL ROOM	SIZE OF 6' X 6' - INSULATED, FITTED WITH GLASS SHIELD FOR FULL ALL-ROUND VIEW		
TOTAL CONNECTED LOAD (KVA)	40	50	62

REVERSIBLE CONCRETE MIXER (LRM SERIES)

FEATURES

- TOWABLE CHASSIS
- INDEPENDENT LOAD CELL FOR HOPPERS
- REVERSIBLE DRUM MIXER
- PLUG & PLAY PLANT



TECHNICAL SPECIFICATION

MODEL (ELECTRIC)	LRM-10	LRM-12	LRM-15
CAPACITY (M ³ /HR)	8-10	10-12	12-15
MIXER TYPE	REVERSIBLE DRUM MIXER	REVERSIBLE DRUM MIXER	REVERSIBLE DRUM MIXER
DRUM CAPACITY (LITRE)	400	600	800
PRIME MOVER	10 HP	12.5 HP	15 HP
NUMBER OF BINS	03 - HYDRAULIC OPERATED WITH HEAVY DUTY POWER PACK		
MATERIAL WEIGHING	INDEPENDENT DIGITAL LOAD CELL FOR EACH BIN		
CONTROL PANEL	ELECTRICALLY OPERATED SEPARATE CONTROL PANEL		
MIXING & DISCHARGE	FORWARD ROTATION FOR MIXING OF CONCRETE & REVERSE ROTATION DISCHARGES THE MIXED CONCRETE		
TYRES AND JACK	04 NOS. OF PNEUMATIC TYRES AND 4 NOS. OF PIN TYPE JACK		
SUGGESTED DG SET (KVA)	25	25	30

BITUMEN & EMULSION SPRAYERS / DISTRIBUTORS

BITUMEN & EMULSION SPRAYERS ARE CONSTRUCTION MACHINES WHICH HELPS IN UNIFORM & CONTROLLED SPRAYING OF BITUMEN / EMULSION ON THE SURFACE PRIOR TO LAYING HOT MIX ASPHALT. THIS EQUIPMENT IS ALSO CALLED ASPHALT DISTRIBUTORS.

TRUCK MOUNTED BITUMEN / EMULSION SPRAYER.

TECHNICAL SPECIFICATION

MODEL	LBDP-6000	LBDP-8000	LBDP-10000
TANK CAPACITY (IN LITERS)	6,000	8,000	10,000
BITUMEN TANK INSULATION (MM)	50 : GLASS WOOL, FULLY INSULATED		
SHELL THICKNESS (MM)	4		
SPRAY BAR	FULLY CIRCULATING		
SPRAY BAR FOLDING LENGTH (M)	2.4 TO 4.2		
NUMBER OF NOZZLES	19		
DRIVE ENGINE	AIR COOLED		
ENGINE HP @ RPM	25 @ 2000		
PUMP	INTERNAL GEAR TYPE		
PUMP CAPACITY (M ³ / HR)	UP TO 130		
COMPRESSOR (HP)	SINGLE STAGE - 2		
COMPRESSOR MAKE	INGERSOLL - RAND		
MANHOLE DIAMETER (MM)	600 MM		
VISUAL DISPLAY OF SPEED (M/MIN)	DIGITAL TACHOMETER WITH SENSOR		
BURNER	LAP TYPE		



TROLLEY MOUNTED BITUMEN / EMULSION SPRAYER.

TECHNICAL SPECIFICATION

MODEL	LBS-3000
TANK CAPACITY (LITERS)	3,000
BITUMEN TANK INSULATION (MM)	35 : GLASS WOOL, FULLY INSULATED
SHAPE SHELL	U
SHELL THICKNESS (MM)	4
MOUNTING	IRON WHEEL BASE CHASSIS WITH WHEELS
DRIVE ENGINE	AIR COOLED
ENGINE HP @ RPM	8 @ 1500
ENGINE MAKE	KIRLOSKAR / EQUIVALENT
PUMP	INTERNAL GEAR TYPE
DIESEL TANK CAPACITY (LITERS)	60
SPRAYER PIPE	3.5 M LONG WITH SPRAY NOZZLE AND HAND HOLDING ATTACHMENT
PULLEY BLOCK CAPACITY (TON)	1 : FOR DRUM LIFTING / LOADING
BURNER	LAP TYPE

ROAD SWEEPER / MECHANICAL BROOM WITH SIDE BRUSH

A TRACTOR MOUNTED HYDRAULIC BROOM IS A CLEANING MACHINE TOWED BEHIND TRACTOR, HAVING HYDRAULIC MECHANISM. THE PRIMARY APPLICATION IS TO CLEAN THE ROAD SURFACE / PARKING LOTS / PAVED / UNPAVED SURFACE, FACTORY PREMISES ETC. IT IS WIDELY USED IN ROAD CONSTRUCTION FOR CLEANING OF ROADS PRIOR TO PRIME COAT / TACK COAT / BITUMINOUS / CONCRETE SURFACE LAYING.

OPTIONS

- SIDE BRUSH FOR CLEANING OF MEDIANS/ FLAKES AND HARD TO REACH AREAS
- WATER SPRINKLER SYSTEM FOR SUPPRESSION OF FUGITIVE DUST EMISSION



TECHNICAL SPECIFICATION

MODE OF OPERATION	: OPERATED CONVENIENTLY BY ATTACHING WITH A TRACTOR HYDRAULICS
SWEEPING WIDTH (METER)	: 2.3
DUST COLLECTION	: INSIDE DUST COLLECTING BUCKET
WHEEL	: TWO HEAVY DUTY RUBBER WHEELS
MATERIAL OF BRUSH	: NYLON / STEEL
NO OF BRUSH SECTION	: 27
MAIN BRUSH DIAMETER (MM)	: 500
HOSE PIPE LENGTH (METER)	: 5
HYDRAULIC DRIVE	: THROUGH 2 HYDRO MOTORS
OPERATING PRESSURE	: MAXIMUM 180 BAR
MACHINE WEIGHT (KG)	: 600



STONE CRUSHERS

STONE CRUSHER IS A MACHINE USED TO REDUCE LARGE ROCKS INTO SMALLER ROCKS, GRAVEL OR ROCK DUST.
CAPACITIES: 25 TO 200 TPH

PRIMARY JAW CRUSHER : TECHNICAL SPECIFICATION

MODEL	FEED OPENING (MM)	MAXIMUM FEED SIZE (MM)	DISCHARGE OPENING (MM)	CAPACITY (TPH)	POWER (KW)
12 X 24	300 X 600	250	40 - 60	25 - 35	37.5
15 X 24	375 X 600	300	50 - 70	30 - 40	37.5
18 X 24	450 X 600	350	50 - 70	35 - 45	37.5
15 X 30	375 X 750	310	50 - 80	40 - 60	45
20 X 32	500 X 800	425	50 - 100	60 - 80	45
24 X 32	600 X 800	500	50 - 100	60 - 85	45
24 X 36	600 X 900	500	65 - 125	80 - 100	75
28 X 36	700 X 900	630	80 - 150	92 - 110	75
32 X 42	800 X 1050	700	95 - 250	150 - 200	112.5
36 X 42	900 X 1050	800	100 - 250	175 - 225	112.5



SECONDARY JAW CRUSHER : TECHNICAL SPECIFICATION

MODEL	FEED OPENING (MM)	MAXIMUM FEED SIZE (MM)	DISCHARGE OPENING (MM)	CAPACITY (TPH)	POWER (KW)
7" X 14"	200 X 350	160	20 - 50	2 - 6	11.25
9" X 16"	225 X 400	200	20 - 50	5 - 15	18.75
10" X 20"	250 X 500	200	20 - 50	8 - 20	22.5
10" X 24"	250 X 600	200	30 - 80	10 - 25	22.5 - 30
10" X 32"	250 X 800	200	30 - 80	15 - 25	30 - 37.5
8" X 36"	200 X 900	170	20 - 50	10 - 30	30 - 37.5
10" X 36"	250 X 900	200	20 - 50	15 - 35	30 - 37.5
8" X 42"	200 X 1066	170	20 - 50	15 - 40	37.5 - 45
10" X 42"	250 X 1066	200	30 - 80	20 - 45	37.5 - 45



CONE CRUSHER : TECHNICAL SPECIFICATION

MODEL NAME	MAXIMUM FEED SIZE (MM)	MINIMUM CSS (MM)	RPM	INPUT CAPACITY (TPH)	POWER (HP)
SC 1000	140	16	630	175	150
SC 1300	210	16	625	230	215
GC 0820	120	22	1015	110	100
GC 0975	150	15	1015	155	150



HORIZONTAL SHAFT IMPACTOR : TECHNICAL SPECIFICATION

SPECIFICATION/MODEL	HSI 400	HSI 300	HSI 150	HSI 75
MAXIMUM FEED OPENING	43 3/4" X 64 3/4" 1099 MM X 1645 MM	43 3/4" X 48 3/4" 1099 MM X 1238 MM	17" X 42" 450 MM X 1066 MM	11" X 38" 300 MM X 965 MM
DISCHARGE OPENING	65" X 64" 1660 MM X 1645 MM	65" X 48" 1660 MM X 1230 MM	46" X 58" 1186 MM X 1492 MM	38" X 35" 970 MM X 907 MM
MAXIMUM FEED SIZE	12" X 22" 304 MM X 558 MM	12" X 22" 304 MM X 560 MM	8" X 10" 203 MM X 254 MM	5" 127 MM
CAPACITY	250 - 400	150 - 300	80 - 150	40 - 70
POWER	298 KW	226 KW	111 KW	44 KW



VERTICAL SHAFT IMPACTOR : TECHNICAL SPECIFICATION

MODEL	VSI 600	VSI 800	VSI 1000
MAXIMUM FEED SIZE (MM)	00-15	00-30	00-40
ROTOR SIZE (MM)	600	800	800
ROTOR SPEED (M/SEC)	50-70	50-70	50-70
ROTOR RPM	1100-1600	1100-1600	900-1300
CAPACITY (TPH)	15-30	25-40	35-50
NOMINAL THROUGHOUT CAPACITY (TPH)	60-90	75-100	90-125
POWER (HP)	75	100	160



VIBRATORY GRIZZLY FEEDER : TECHNICAL SPECIFICATION

MODEL	MAXIMUM FEED SIZE (MM)	CAPACITY (TPH)	POWER (KW) (WITH VIBRO MOTOR)	POWER (HP) (SHAFT DRIVEN MOTOR)
VGf 2200 X 700	350	30 - 50	1.1 X 2	7.5 HP
VGf 3100 X 800	350	60 - 80	2.2 X 2	10 HP
VGf 3100 X 1100	500	70 - 100	4.3 X 2	15 HP
VGf 4100 X 1100	700	125 -200	4.3 X 2	20 HP



VIBRATING SCREEN : TECHNICAL SPECIFICATION

MODEL	SCREEN SIZE (FOOT)	DECK	MESH SIZE (MM)	CAPACITY (TPH)	POWER (HP)	AMPLITUDE (MM)	ANGLE (°)
2420 X 1200	8' X 4'	2/3	6~150	10 - 20	7.5	7~11	20
3000 X 1200	10' X 4'	2/3	6~150	15 - 25	7.5/10	7~11	20
3600 X 1200	12' X 4'	2/3	6~150	20 - 30	10	7~11	20
3600 X 1500	12' X 5'	2/3	6~150	20 - 40	10 - 12.5	7~11	20
4200 X 1500	14' X 5'	2/3/4	6~150	40 - 60	12.5 - 15	7~11	20
4800 X 1500	16' X 5'	2/3/4	6~150	60 - 125	15 - 20	7~11	20
5400 X 1500	18' X 5'	2/3/4	6~150	125 - 150	20 - 25	7~11	20
6000 X 1500	20' X 5'	2/3/4	6~150	150 - 200	25 - 30	7~11	20
6000 X 1800	20' X 6'	2/3/4	6~150	225 - 300	30 - 40	7~11	20



BELT CONVEYOR : TECHNICAL SPECIFICATION

WIDTH (MM)	LENGTH (M)	POWER (KW)	SPEED (M/S)	CAPACITY (T/H)
400	12~20/2~2.4	20~25/3.5~7.5	1.25~2.0	30~60
500	12~20/3~5.5	20~30/5.5~7.5	1.25~2.0	40~80
650	12~20/4~5.5	20~30/5.5~11	1.25~2.0	80~120
800	10~15/4~5.5	15~30/5.5~15	1.25~2.0	120~200
1000	10~20/5.5~11	20~40/11~22	1.25~2.0	200~320
1200	10~20/7.5~15	20~40/15~30	1.25~2.0	290~480



ROAD MARKING MACHINE

THE ROAD MARKING MACHINE IS AN EQUIPMENT USED TO DELINEATE DIVERSE TRAFFIC LINES ON BITUMINOUS AND CONCRETE ROAD SURFACE IN ORDER TO PROVIDE GUIDANCE AND INFORMATION TO MOTORISTS AND PEDESTRIANS.

ROAD MARKING MACHINE, MODEL LRMM - 300 : TECHNICAL SPECIFICATION

- STAINLESS STEEL TANK OF 100 KG WITH MANUAL AGITATOR
- MARKING SCREED BOX OF 100 MM & 150 MM EACH
- THICKNESS ADJUSTMENT WITH ROTATING KNOB.
- GLASS BEAD SPRAYING MECHANISM OF 100 MM & 150 MM EACH
- 10 KG. GLASS BEAD STORAGE CONTAINER WITH INDICATOR
- BIMETAL PAINT TEMPERATURE GAUGE
- STRAIGHT & FINE ALIGNMENT OF MARKINGS THROUGH REAR WHEEL AUTO LOCK
- LPG BURNERS, TORCH, VALVES, ADAPTORS ETC. ATTACHED ARE OF REPUTED AND RELIABLE MAKE
- OPERATOR PROPELLED



COLD PAINT MARKING MACHINE (DOUBLE GUN), MODEL LRMM - 200 : TECHNICAL SPECIFICATION

- ADVANCE PRESSURE CONTROL AIRLESS SPRAY ROAD MARKING SYSTEM FOR CONSISTENT, EVEN AND UNIFORM SPRAY
- FAST LINE MARKING SYSTEM, USEFUL FOR CURVED SURFACE AND RUNWAYS
- 6.5 HP PETROL ENGINE FOR OPERATION OF MACHINE
- MAXIMUM FLUID WORKING PRESSURE - 3300 PSI
- WEIGHT - 154 KG
- FLOW RATE - 2.3 LPM
- SUITABLE FOR SPRAYING ENAMELS, ACRYLICS, WATER AND SOLVENT BASED PAINTS



RIDE ON AUTOMATIC THERMO PLASTIC ROAD MARKING MACHINE, MODEL LRMM - 100 : TECHNICAL SPECIFICATION

- 13 HP AIR COOLED DIESEL ENGINE WITH ELECTRIC STARTER SYSTEM
- DRIVING SPEED 0 - 10 KM/HR.
- MARKING SPEED 0 - 2 KM/HR.
- PNEUMATICALLY ACTIVATED 100 MM AND 150 MM SCREED SHOE
- PRESSURIZED GLASS BEAD CONTAINER OF 100 KG.
- GLASS BEAD SPRAY GUN WITH CHANGEABLE NOZZLES FOR ROAD MARKING
- AUTOMATIC SKIP LINE DEVICE TO CONTROL THE SCREED SHOE AND GLASS BEAD SPRAY GUN
- PAINT TANK OF 350 KG WITH HYDRAULICALLY OPERATED STIRRER SYSTEM
- MANUAL STEERING SYSTEM



THERMOPLASTIC PRE-HEATER : TECHNICAL SPECIFICATION

- THIS UNIT FEEDS CONTINUOUSLY HEATED THERMOPLASTIC PAINT TO THE ROAD MARKING MACHINE (APPLICATOR)
- STAINLESS STEEL TANKS OF 300 KG / 500 KG
- HIGH-PRESSURE INDUSTRIAL TYPE LPG BURNERS FOR HEATING OF THERMO PLASTIC PAINT, THERMIC OIL AND SCREED
- SEPARATE TEMPERATURE GAUGE FOR PAINT AND THERMIC OIL
- 5 HP AIR COOLED DIESEL ENGINE FOR POWERING AGITATOR DRIVEN BY 3" - 15:1 GEARBOX FOR AGITATION OF PAINT INSIDE TANK



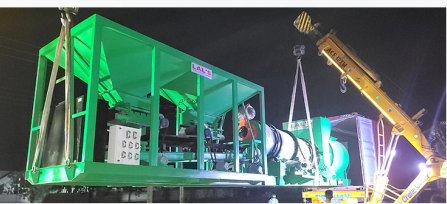

FOLLOW US ON : LALSEXPORTERS /



LAL'S
ASPHALT & CONCRETE EQUIPMENT

CIN - U32909BR2016PTC032154
GSTIN - 10AADCL1199F1ZV

LAL'S EXPORTERS (INDIA) PVT. LTD.

REGISTERED OFFICE

LAL'S
HOUSE NO. 1, ROAD NO. 07
NORTH JAI PRAKASH NAGAR, PO - ASHIANA
PATNA, BIHAR - 800 025, INDIA

FACTORY

AHMEDABAD, GUJARAT, INDIA

INDIAN NETWORK

J&K, HARIDWAR, GUWAHATI, JABALPUR, NAGPUR

OVERSEAS NETWORK

DUBAI, ZIMBABWE, GHANA, ALGERIA

INFO@LALSEXPORTERS.COM
LALSEXPORTERS@GMAIL.COM



+91 87575 95777

+91 87570 14777

+91 87575 48777



www.lalsexporters.com / www.lalsequipment.com